

Series **84L2-1** Product Overview

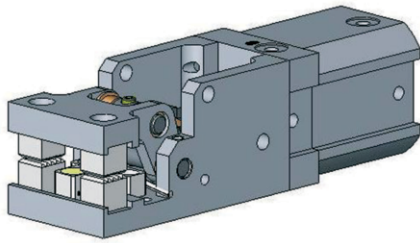

Application:

Gripping, Holding, Placing, Removing and Transporting of metal sheets and other parts, mainly in jigs, press-automation and handling systems.







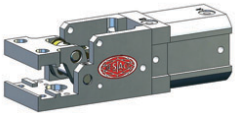
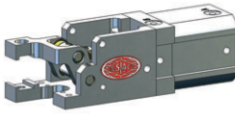
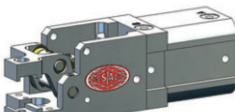

Features:

- Compact modular design
- Fast opening and closing action
- Mounting lateral and rear possible
- High clamping force
- Interchangeable in mounting dimensions with 84A2-1
- Add-on component and end position sensing available

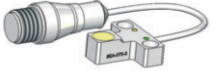
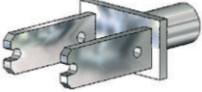
Major spare parts

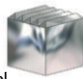
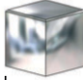
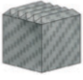
Specification	Order no. for 84A2-1
Cylinder	8PW-108-1
Seal kit	8PW-108-1-00

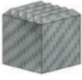
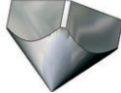
Order no. Example: **84L2 - 11 D4 0 BA BA**

<p>84L2-11 = Base model straight design</p>  <p>84L2-14 = Base model small, right version</p>  <p>84L2-16 = Base model small, left version</p>  <p>Base model</p>	<p>00 = without sensing system</p> <p>D4 = 8EA-075-2 switching distance 3,0 mm with 2m cable</p>  <p>D7 = 8EA-075-3 switching distance 3,0 mm with plug M12 x 1</p>  <p>Sensing system</p>	<p>0 = without adapter/accessories</p> <p>I = 8MA-165-1 – Ø20 mm J = 8MA-166-1 – Ø25 mm Z = 8MA-168-1 – Ø 1"</p>  <p>V = 8MA-147-1</p>  <p>W = 82ZB-025-2</p>  <p>Adapter</p>	<p>00 = without gripper teeth</p> <p>BA = 8JZ-027-1 10x10x10 Steel</p>  <p>BB = 8JZ-028-1 10x10x10 Steel</p>  <p>KF = 8JZ-045-1 10x10x10 PU-90 Shore plastic</p>  <p>Gripper teeth steel/ plastic, lower</p>	<p>00 = without Gripper teeth/points</p> <p>BA = 8JZ-027-1 10x10x10 Steel</p>  <p>BB = 8JZ-028-1 10x10x10 Steel</p>  <p>KF = 8JZ-045-1 10x10x10 PU-90 Shore plastic</p>  <p>PH = 8JZ-029-1 Steel</p>  <p>Gripper teeth/points steel/ plastic, upper</p>
<p>Shims for gripper teeth ordering-no.: 8SB-003-1 (to be ordered separately) Dimensions: 10 x 10 x 0,1 mm</p> 				

Gripper jaw, top: Gripper teeth, Gripper points, Crown teeth – Dimensions see page 17.52, 17.53, 17.54 and 17.55
Gripper jaw, bottom: Gripper teeth, Gripper points, Crown teeth – Dimensions see page 17.52, 17.53, 17.54 and 17.55
Adapters / Limit stops – Dimensions see page 17.55, 17.56 and 17.57
Sensing systems – Dimensions see page 17.58

Series **84L2-1** Technical Information

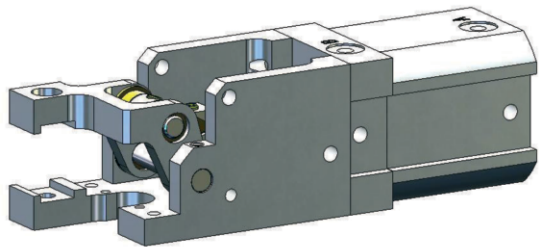

84L2-14000000

Model	Gripping force at 5 bar N [lbs]	Piston Ø mm [in]	Air consumption per double stroke at 5 bar dm ³ [ft ³]	Weight ~ Kg [lbs]	Min Opening time sec.	Min Closure time sec.
84L2-14...	74 [17]	25 [0.98]	0,19 [0.01]	0,37 [0.81]	0,2	0,2

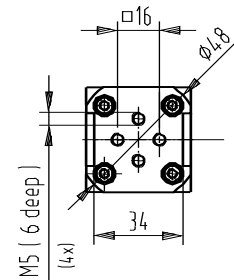
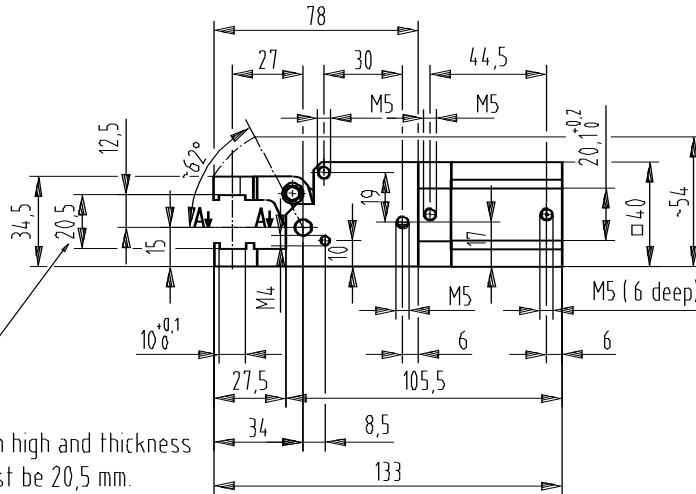
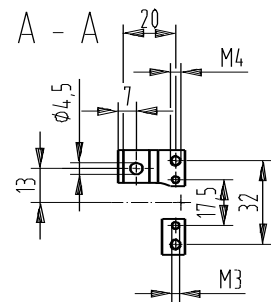
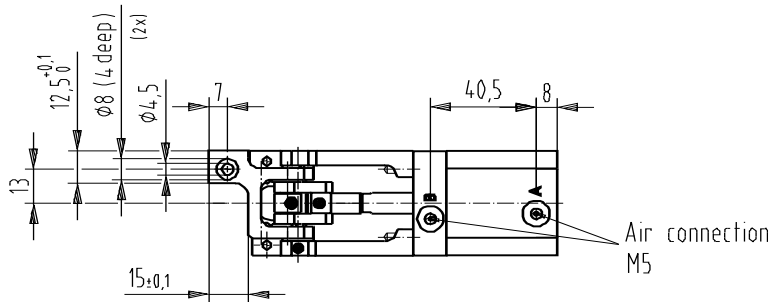

Note!
Addition of gripper teeth high and thickness of the clamped plate must be 20,5 mm.
If might be necessary to use shim plates or of grind the gripper teeth.

Note!
Any extension of the movable, or the fixed gripper jaws as well as the additional attachment of weights will repeal the guarantee.

Medium air, max. 6 bar
Operation with oil-free air is permissible.

Turning cyl.-air connection possible in 4x 90° increments.

