

Series **82M-5** Product Overview (last time in catalog)

Features:

- Modular design
- Lightweight aluminum body
- Protected from dirty environments
- Field-adjustable opening angle
- Sealed roller bearing
- Multiple mounting surfaces
- Manual versions available

Application:

- Assembly
- Checking fixtures
- Handling systems

82M-5 Series



Simple adjusting of opening angle (pictures show sensor-box separated from clamp)



120° Opening angle
(delivery condition)

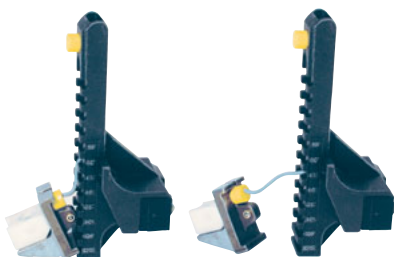

Click-out of bumper

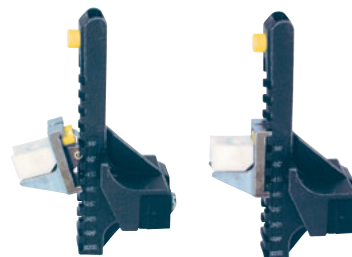

Click-in in new position (60°)
(sensor box fit for reassembling to clamp)

Model	Max. holding torque Nm [lb ft]	Max. Clamping Torque at 5 bar [72 psi] Nm [lb ft]	Weight kg [lb]	Max Opening Angle	Cylinder Size mm [in]	Air Consumption (per double stroke) at 5 bar [72 psi] dm ³ [ft ³]
82M-5	800 [590]	270Nm [199]	3,3 [7.3]	120°	50 [1.97]	2,2 [0.08]

82M-5 Pre-Configured Clamp Quick-Order Numbers





Quick Order	Sensor	Handle
82M-5230050000		
82M-5230050C80	X	
82M-523KR50000		X
82M-523KR50C80	X	X

Series **82M-5** Ordering Information, Standard Clamp Dimensions

Order No. code for 82M-5...

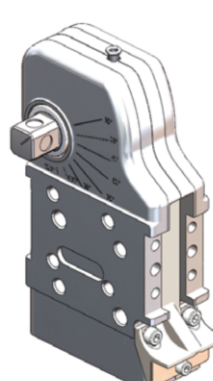
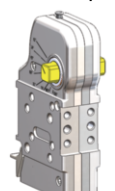
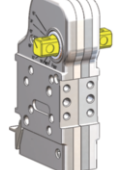
Example Order No.: **82M-5 23 K R 50 C8 0**

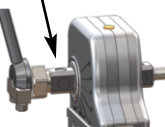
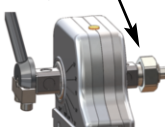
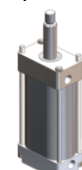

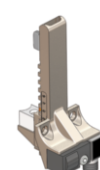
<p>82M - 5</p>  <p>Basic Model</p>	<p>03 = drive shaft for U-clamp arm</p>  <p>23 = drive shaft for lateral clamp arms</p>  <p>Drive Shaft</p>	<p>0 = without hand lever</p> <p>K = with hand lever, welded 8KB-053-1</p>  <p>S = hand lever, attached (weldable) 8KB-052-1</p>  <p>Hand Lever</p>	<p>0 = without hand lever</p> <p>L = spring assembly "left"</p>  <p>R = spring assembly "right"</p>  <p>Cylinder</p>	<p>50 = G1/4 pneum. cylinder Ø50</p>  <p>5N = 1/4-18 NPT pneum. cylinder Ø50</p>  <p>Cylinder</p>	<p>00 = without sensors</p> <p>C8 = inductive sensing system</p>  <p>D8 = inductive sensing system</p>  <p>Inductive Sensing System</p>
---	--	---	--	--	---

Model	B23 max.	L17
82M-5030050..	72	12
82M-5230050..	90	21

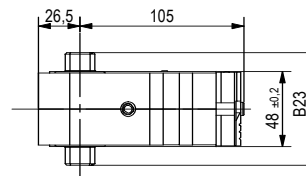

mm [INCH]
THIRD ANGLE PROJECTION

Dimensions of the driven shaft

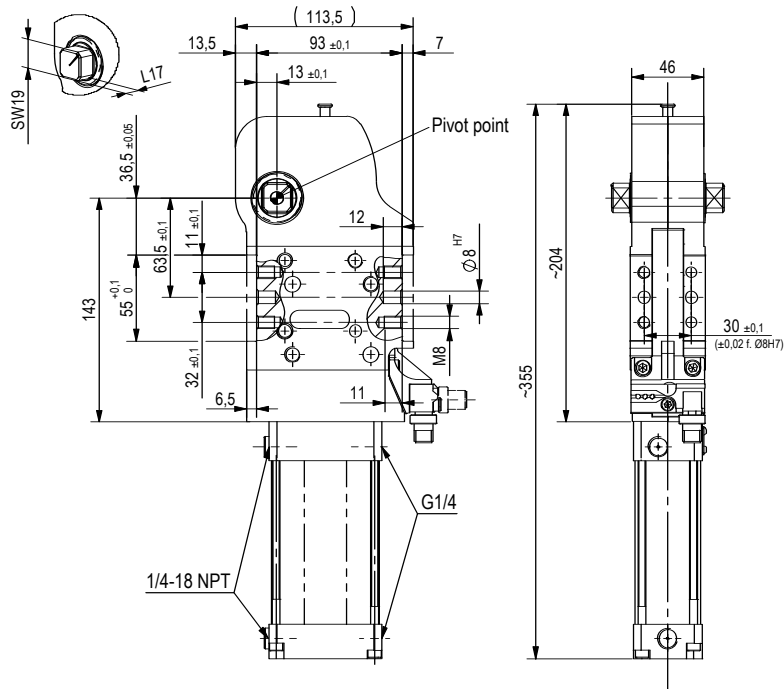
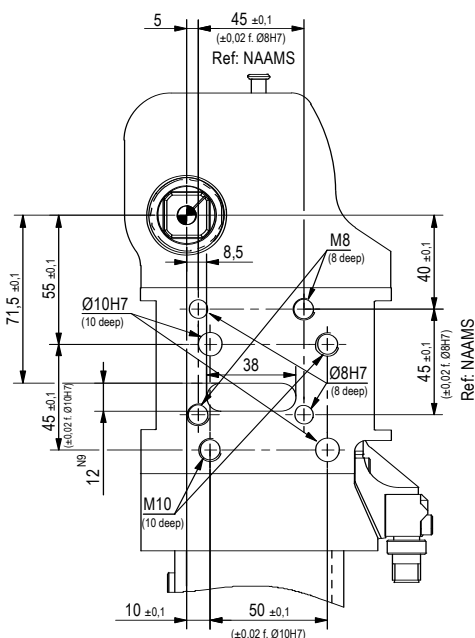

Power by compressed air, max. 6 bar
Operation with oil-free air is permissible.

Series **82M-5** Handle Option

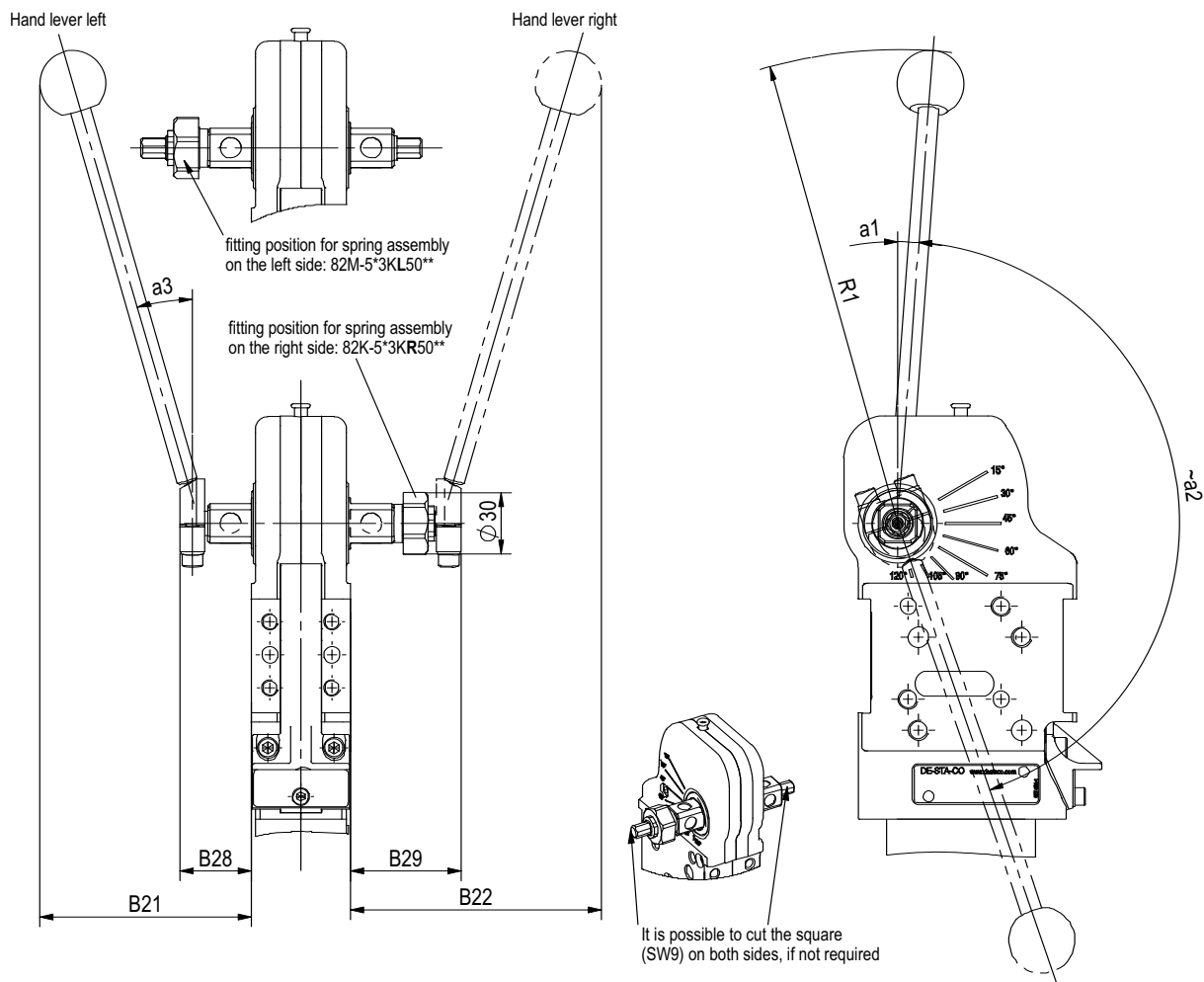

Model	$\alpha 1$	$\alpha 3$	B21	B22	B28	B29	R1
	~	~	~	~	max.	max.	~
82M-523S...	-	-	-	-	37	55	240
82M-523K...	5°	16°	104	124			

Model	Hand lever slew angle $\alpha 2$ with reference to opening angle of clamping arm							
	15°	30°	45°	60°	75°	90°	105°	120°
82M-523K...	55°	67°	82°	98°	113°	129°	144°	161°

Series 82M-5 Clamp Arm Variants

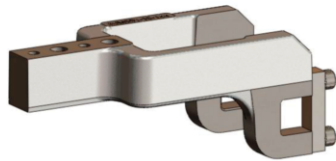

U bar central L5 = 15 mm



U bar central L5 = 25 mm



U bar central L5 = 45 mm

U-bars Central Technical Information

Model	Order no. for set U-clamp arm, central	Opening angle 90° version tolerance: + 5°	Opening angle 180° version tolerance: + 5°	Weight (kg)
82M-503 _ 50	8UM501-15-144	120°	105°	1,1
82M-523 _ 50	8UM501-25-144		120°	
	8UM501-45-144			

Model	Order no. for set U-clamp arm, central	B2	B4	B9	B10 ±0,02	B11 +0,1	B12 ±0,2	B26	B27 +0,2	D2 H7	D3	L4 ±0,1	L5 (- 0,5° max)	L10 ±1,2	L10a ~	R1 ~	R2 ~	SW +0,02 -0,009
82M-503 _ 50	8UM501-15-144												15					
82M-523 _ 50	8UM501-25-144	144	64.3	9	30	105	30	95	48.1	6	9	28	25	20	19	75	32	19
	8UM501-45-144												45					

View X
(for dimensioning)

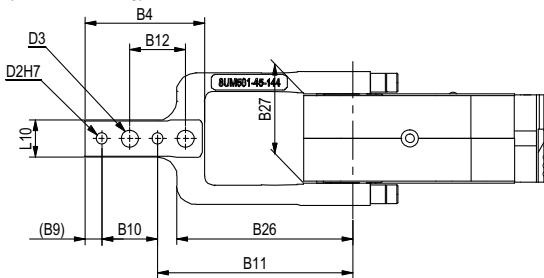

90° version

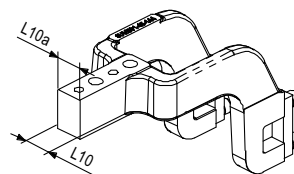

U-clamp arms, central

180° version

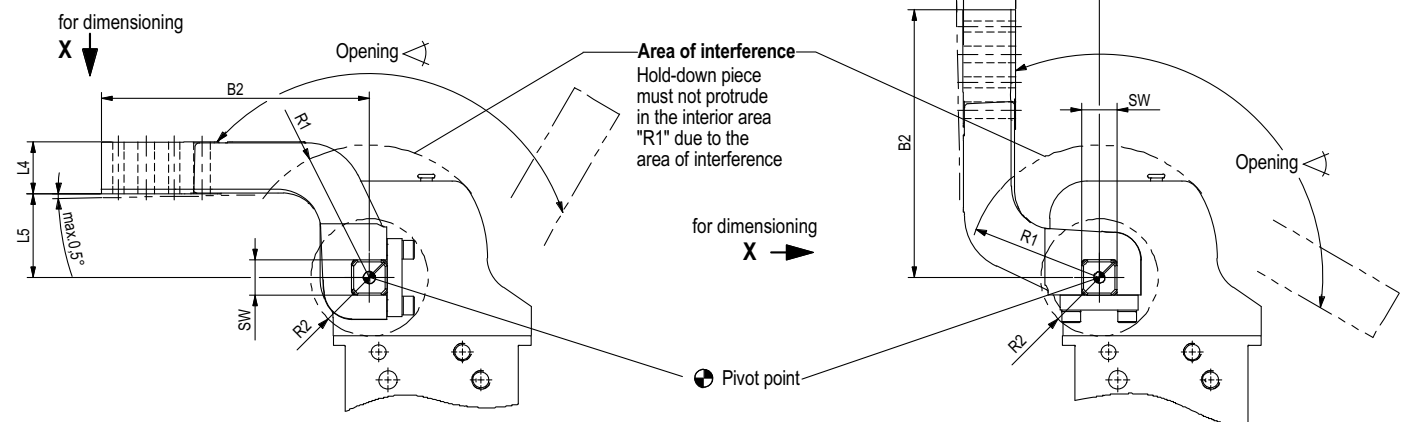

Series **82M-5** Clamp Arm Variants



Lateral arm L5=15mm



Lateral arm L5=25mm

Lateral Arm Technical Information

Model	Order no. for set U-clamp arm, lateral	Opening angle 90°-vers.	Opening angle 180°-vers	Weight [kg]	B2	B4	B9	B10 ±0,02	B11 ±0,1	B12 ±0,2	B22	D2 H7	D3	L4 ±0,1	L5 (0,5° max)	L10	R1	R2	SW J7
82M-5...	8JG-070-1-01	120°	105°	0,9	144	74	9	30	105	30	10	6	9	28	15	20	80	28	19
	8S501-25-144	120°	120°	1,0	144	74	9	30	105	30	10	6	9	28	25	20	80	28	19

90°version

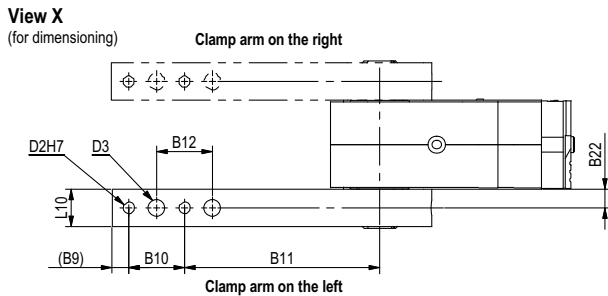

Lateral clamp arms

180°version

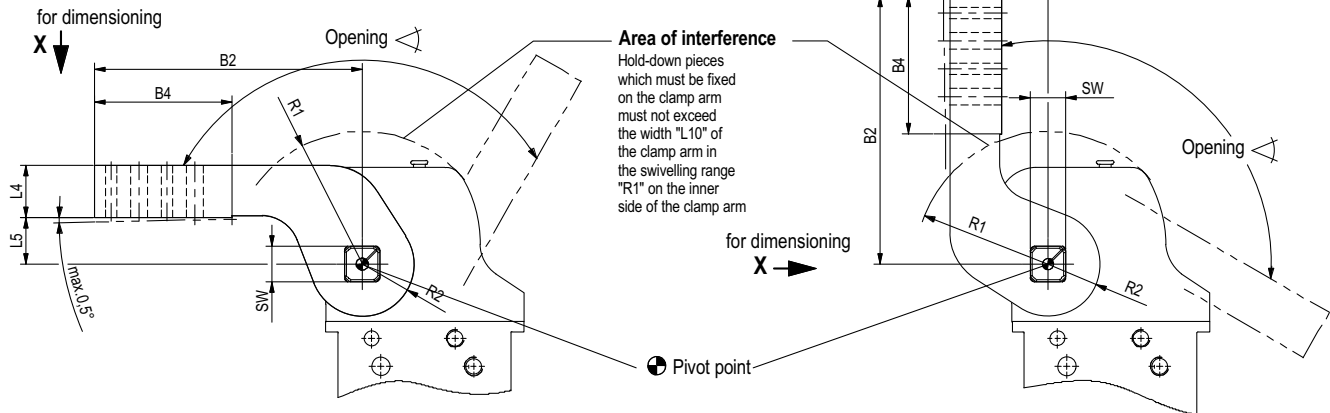

mm [INCH]
THIRD ANGLE
PROJECTION

Series 82M-5 Clamp Arm Data (NAAMS)

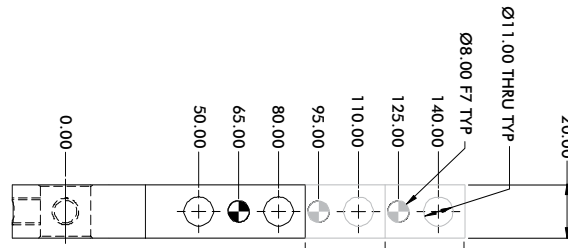
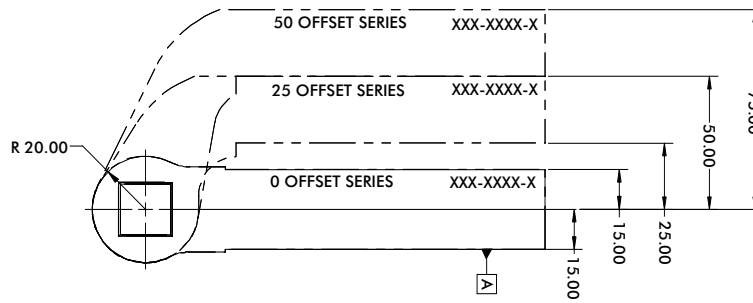

(*) STANDARD ARM OFFERING

OFFSET	ARM STYLE	PART NUMBER
50	*228	B8JG-1228-1
25	*218	B8JG-1218-1
0	*208	B8JG-1208-1

OFFSET	ARM STYLE	PART NUMBER
50	*227	B8JG-1227-1
25	*217	B8JG-1217-1
0	*207	B8JG-1207-1

OFFSET	ARM STYLE	PART NUMBER
50	*226	B8JG-1226-1
25	*216	B8JG-1216-1
0	*206	B8JG-1206-1

Arm Opening	120°	105°	90°	75°	60°	45°	30°	15°
Cylinder Stroke	76.0	68.5	61.3	54.2	46.8	39.3	31.6	21.1

Series **82M-5** Technical Information

Concept guideline

(with reference to axis of clamping arm rotation)

Maximum Tooling Weight 82M-5

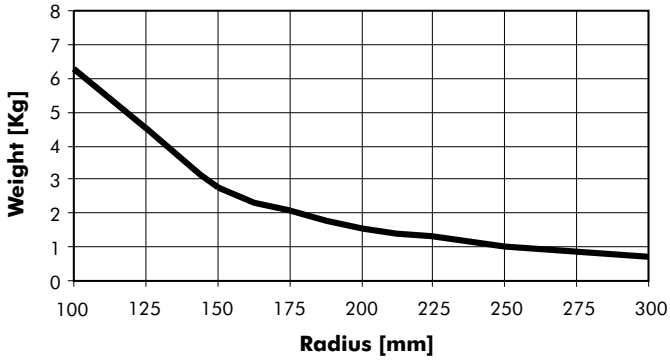

All details apply under an air pressure of 6 bar and opening and closure times of 1 second each.

Wiring diagram of electrical sensing system

Sensing system immune to interference from d.c. arc welding and a.c. arc welding

Pin assignment

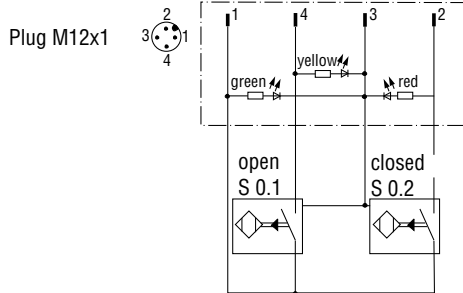
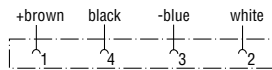

Inductive design:

- C8 Connecting plug M12x1, parallel with cylinder
- D8 Connecting plug M12x1, 90° swivel

Diagram of clamping force (at 5 bar)

Model 82M-5....5*..

