

Series 515 Product Overview

Features:

- Hardened steel pins and bushings strength and long life
- Replaceable pivot pins
- Large, solid clamping arm is easily modified to suit application requirements

Applications:

- Welding
- Assembly
- Light machining
- Medium to heavy duty clamping applications

Also Available:

See page 8.1 for accessories

515
Weldable Base
Solid Bar

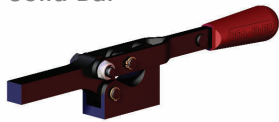

515-B
Flanged Base
Solid Bar

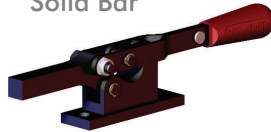

Series 515 Technical Information

Model	Max. Holding Capacity	Clamp Bar Opening (+10°)	Handle Opening (+10°)	Weight
515	3560 N [800 lbf]	85°	72°	0,73kg [1.60lb]
515-B				

Series 515 Holding Capacities

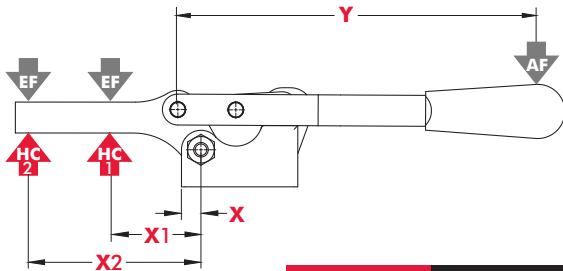

Model	X	X1	X2	Y	‡HC1	‡HC2	‡EF(X1):AF	‡EF(X2):AF
515	[0.31] 8	[1.50]	[2.63]	[5.51]	[800lbf.]	[400lbf.]	11:1	5:1
515-B	[0.94] 24	38	66,8	140	3560N	1780N		

Dimensions shown "mm [inch]" ‡ HC = Holding Capacity, EF = Exerting Force, AF = Applied Force
Refer to page 20.5 for additional information.

Series 515 Standard Clamp Dimensions

515
Weldable Base
Solid Bar

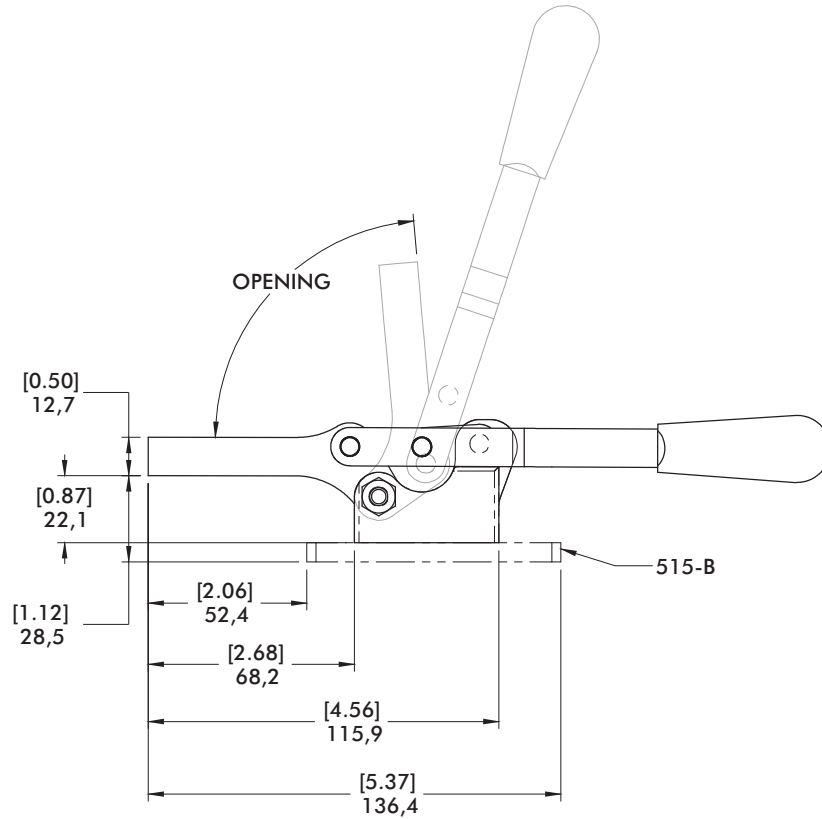
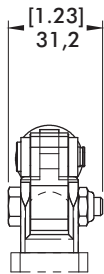
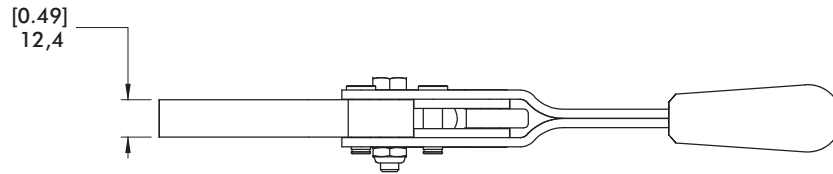
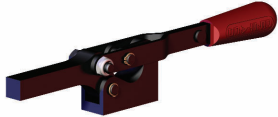

515-B
Flanged Base
Solid Bar

